

Issue 002 / April, 2023



**TYNDALE**  
CHRISTIAN SCHOOL  
God's Truth Prevails



# tyndalian times



# Contents

What's in  
this issue

Message from Board Chair	03
Capital Works	04
Old Tyndalians	06
Salisbury East Campus	08
Strathalbyn Campus	10
Murray Bridge Campus	12
Generations	14
Then VS Now	16



## Book a School Tour

Tyndale runs termly School Tours to give prospective Tyndalians a look into how we function as a School, across all three campuses. Our drive at Tyndale is to be intentionally Christian, intentionally inclusive, and intentionally excellent in everything that we do, and to make sure everyone belongs as a part of the Tyndalian family. Tours are a fantastic way to display this, and we welcome everyone considering Tyndale to attend a scheduled tour.

Read more about our School Tour dates for 2021 on our website. Head to [tyndale.sa.edu.au](http://tyndale.sa.edu.au) and navigate to your specific Campus, Enrolments and Tour Now.



# Belonging as a Tyndalian

From our  
Board Chair –  
Ashley Bennett



Christian education has been a long-term passion of mine. My Tyndale journey started back in 2005 when I was employed as a Senior School teacher at Salisbury East. Since then, I have had children enrolled at the School since 2009 and was elected to the Board of Governors in 2019, and then as Chair in 2020.

One of the many things that I love about our Schools is that across these different contexts there has always been a place for me to identify and belong as a Tyndalian. This has looked different in the varied seasons of life but there has always been an open invitation to engage with the Tyndale community.

The core reason that I believe is behind this is that we are a faith driven community and intentionally Christian. Being Tyndalian joins us to more than just our School community but to the very Kingdom of God where we reflect His glory and goodness to the best of our ability. Being Tyndalian is to allow God's truth to prevail and so we can find our identity, love, and acceptance in Him and where every individual is valued because they bear the image of God.

# Building for the future

## Capital works

### Salisbury East

## Nature Play Area

In 2022, the new Nature Play area construction was completed in the Reception to Year 1 region. The blank canvas of the play area has been reimagined utilising the oval periphery for nature play apparatus surrounding the lawn area.

The diverse creation-intensive area includes:

- A pond disguised as a sand pit with a jetty and boat.
- A mud kitchen encouraging would-be chefs to create wondrous recipes.
- Climbing opportunities abound with numerous fort-like platforms, rope apparatus, cargo nets and a mini-climbing wall.
- Log pathways, a dry creek bed, metal dome-rooms and two shop-like cubbies, ensuring students never run out of things to do.
- Plantings of bamboo, grasses and fruit trees support a few spaces where students may get momentary solitude to contemplate the natural environment or sit and reflect.

The Junior School is delighted to host this eclectic new section of play for our youngest group of students, as it is imperative they can create and explore from as young an age as possible.



*Intentionally Excellent*

### Strathalbyn

## Upgraded Resource Centre

Our Strathalbyn campus is experiencing an overhaul of its existing Resource Centre. The \$1.45 million upgrade and refurbishment align with the School's ever-growing community and the demand for its learning spaces to be enlarged and will give a modern and sophisticated feel to the multi-purpose building that sits at the entrance to our School on East Terrace.

Our relocated and newly designed Resource Centre for student and staff use will provide many opportunities for students to pursue academic excellence and innovation in fresh spaces purpose-designed for their engagement. It will contain an information zone, small group and individual spaces, collaborative areas, a reading nook, and a think tank meeting room. The centre will integrate our learning hub and ICT staff.

A redesigned Food and Hospitality facility will be deployed behind the new Resource Centre, which will be used by Middle School and Senior School Students.

The former Resource Centre will be converted to classrooms over the 2022 to 2023 summer break. The new spaces will be completed in 2023.

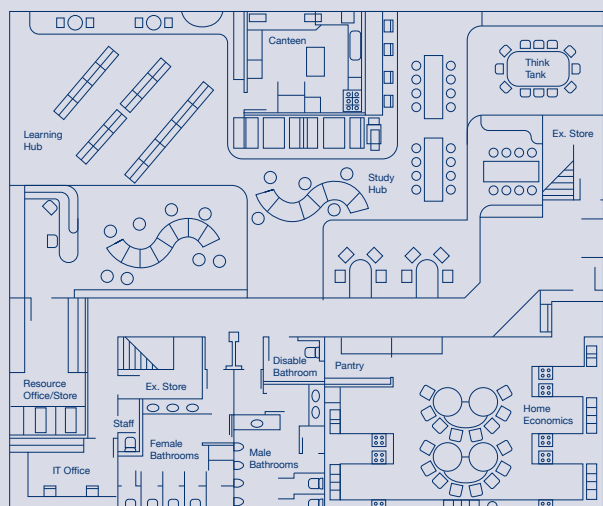



*Making  
a huge  
difference*

Murray Bridge  
Principal  
Tom Cowell



## Murray Bridge

### *Learning Support Centre*

The new Learning Support Centre currently under construction, and opening in early 2023, will provide our Murray Bridge campus with outstanding, personalised facilities to support the extensive support programmes we have in place for students with specific learning needs.

The heart of the Centre will contain two purpose-built classrooms that will cater for our growing Small Class classes.

This is in addition to office spaces that will accommodate both the Tyndale Learning Support staff team and the many external healthcare providers that frequently visit our School to work with students.

The classrooms will have adjoining withdrawal and sensory spaces to care for the needs of individual students throughout the school day.

Students will also have access to flexible, general-purpose learning spaces.

These facilities will significantly enhance the already excellent level of support we provide to our young Tyndalians, and we are extremely excited to see this Centre open, as one of many exciting developments to our facilities in the years to come.



# Reaching amazing heights!

Old Tyndalians

## Salisbury East

Robert Taylor

(Class of 1986)

Robert has built an extensive career in law enforcement since graduating from Tyndale.

Since graduating from Tyndale in 1986, Robert found a career in the field of digital forensics. He established a love for technologically intensive activities from an early age and has dedicated a substantial portion of his life to serving in this field.

God-focused and hard-working, Robert had this to say about his healthy balance: 'As one of God's kids, it is a privilege to be in the position where I am making a difference in what I do every day. The work I do involves locating specific evidence in relation to alleged criminal activity and misconduct. My involvement flows right through to the courts of law where I can be called to give expert testimony that will either assist in proving or exonerating the alleged activity.'

When asked about any words of encouragement for aspiring Senior School students today, he kept it simple: 'My big tip would be to believe in yourself and that you can achieve anything!'

## Murray Bridge

Sheridan Sydenham

(Class of 2020)

Sheridan is currently studying a Bachelor of Nutrition and Dietetics and is a competitive body builder.

Sheridan graduated in 2020 from our Murray Bridge campus and has since gone on to study at Flinders University.

She had this to say about her tenure at Tyndale: 'I loved the amazing staff and one-on-one support. Without this help and the ability to study in a quiet space I would not be where I am today.'

When asked about her favourite teacher at Murray Bridge, she said: 'Mrs Bronwyn Hammat is the teacher I remember the most. She always found a way to incorporate life skills into her teaching, which I am extremely thankful for.'

Partnered with her educational success, Sheridan has also established herself as a competitive body builder, competing in three competitions this year.

## Strathalbyn

Chloe Barham

(Class of 2016)

Chloe is studying a Bachelor of Primary Education after moving on her own to Queensland.

Chloe enjoyed a fresh start since finishing at Strathalbyn in 2016, relocating to Queensland to pursue teaching after shifting her career from hairdressing.

'I started with Hairdressing, completing my Certificate III, and I worked in that field for a bit before I decided it was time for something else,' she said.

'In 2021, I enrolled at the University of the Sunshine Coast in Queensland in Primary Education and have since had a placement with Year 2's. It was amazing to work with students of all different learning abilities.'

Chloe was well-equipped for the career change thanks to Tyndale, stating: 'Tyndale put the effort in to help explore different options for me. All my teachers I had during my time encouraged me for varied reasons. They all had an impact on my journey as well as the friends I made along the way.'





Robert Taylor



Sheridan Sydenham



Chloe Barham



# Inspired by God

Salisbury East  
Campus



## RISE

The uniqueness of a Middle Years curriculum means that we can create environments and adopt programmes where the transition to young adulthood can be nurtured and explored.

In 2021, we launched our Rite Journey programme, and it complements our values and beliefs about Middle Schooling. Over the course of the year, all Year 9 students are exposed to a series of physical, personal, and spiritual challenges

that are designed to stretch them, promote conversation, and give them a sense of achievement.

Single sex groups of no more than sixteen students are assigned to a leader who works to develop trust and safety to promote vulnerability. Topics such as body image, identity, relationships, responsibility, and resilience are explored, pulled together by a common thread that represents a move from childhood to adulthood.

Students attend a challenge camp where they spend a solo night by themselves, participate in mentor activities and initiate a Service-Learning project, all designed around understanding themselves better.

The Rite Journey also recognises the parent's role in this transition to adulthood and helps to facilitate deeper conversations at home.



## Intentionally Excellent

The Wellbeing Team that covers our three Tyndale Christian School campuses is like no other in South Australia.

Principals, Politicians, Board members, Teachers, Counsellors and a myriad of other leaders and wellbeing staff from schools across Australia come to visit Tyndale to look at our model.

Almost twenty years ago we started with one Counsellor at Salisbury East, three days per week. Now, Tyndale employs professional staff, including a Burmese-speaking Counsellor, Family Therapists, Nurses, Social Workers and First Aid Staff across the three sites, equating to 21 staff in total.

While these staff have distinct roles to play in our Schools, they also work collaboratively for the best possible outcomes, not just for the students at School, but for their whole family network.

Our four therapy dogs, three at Salisbury East and one at Murray Bridge, create moments of nurture and comfort for students, families, and staff alike.

## Pastoral Care

In 2022, a dedicated group of Year 12 students formed a committee and, with the support of their Pastoral Care Leaders, proposed the idea of a Year 12 Camp to Senior School leaders and Mr Mike Potter.

The aim was to celebrate their final year at Tyndale by partaking in an all-inclusive camp; a chance for the Year 12 cohort to come together to rest, reflect, recharge, and spend time growing in their faith.

Their attention to detail and passion to see their idea come to fruition inspired the leadership team to make it a reality, and in the final week of Term 2 the students participated in the inaugural Year 12 Camp.

The camp included several collaborative activities such as a Worship night and an Amazing Race inspired game. The Worship night was powerful, with students praising God, hearing about His purpose for their lives and praying for one another.

Students made the most of the opportunities, with lots of peer encouragement, laughter, and heartfelt bible-based workshop electives where they explored big questions around God, faith, and the world. So much care for one another was evident throughout the camp.



*Pastoral Care*



*Intentionally Excellent*



# Collaborating and achieving

Strathalbyn  
Campus



## Intentionally Excellent

The KindiCare Rating is a unique rating designed to enable parents and guardians, childcare providers, educators, and the government to compare the quality of childcare services provided in Australia.

Families can use the KindiCare site to search for services in their area. A search was conducted in Strathalbyn, and it reflects that our ELC is the highest-ranked service in the area, with a rating of 'Very Good'. As a School, we strive to be excellent in everything we do, and this rating directly correlates with our morals.

We pride ourselves on the care and attention shown towards the children, and the personalised interaction and communication with the parents regarding the child's progress are beneficiaries of our advanced education.



## RISE

In 2022, we had a very enthusiastic and energetic STEM-based Buddy Class at our Strathalbyn campus. Our Year 5 and Year 10 classes collaborated for the day as the two groups helped each other build and race elastic band powered vehicles.

It was great to see the younger buddies take the lead and teach their older buddies a trick or two when building the vehicles. The comradery between the different age groups embodied everything our RISE values stand for.

The aim behind our Buddy Class is to develop connections between our sub-schools, and to get our older students working with our younger students to create some life skills and display our School values.

## Pastoral Care

In 2023, some significant changes to our Pastoral Care structure are being implemented to partner with our four House teams: Angas (blue), Murray (yellow), Finniss (red) and Bremer (green). Vertical home groups will be introduced, consisting of a blend of Year 6 to Year 12 students in each group, depending on their House team. There will be two vertical classes in each of the representative House groups, sustaining optimal class sizes.

The concept behind this is that our Senior students will act as mentors to the younger students, as these students will be in the same class group from Year 6 until they finish schooling. In essence, each House will become its own family.

The students will have the same home class teacher from Year 6 until Year 12. The benefits of this are that the teacher will have a greater understanding of the students in their Home Group and will be able to grow with the student during their time at Strathalbyn. They will exemplify the leader and role model the student requires and will be an advocate for parents to communicate with frequently regarding their child's education.





# Serving Others

Murray Bridge Campus



## RISE

Our Murray Bridge campus concerns itself with developing people who will influence the world. We want to see our students emerge as the absolute best people they can be so that wherever they may find themselves in life, they will not be afraid to step out and lead.

Our third graduating Year 12 class is no exception. In Week 2, Term 4 of 2022, we held our annual Passing of the Light Chapel. In this service, we saw the current Year 12 students pass on the light to the next class to lead the school student body.

For us this is extremely important because we want our students to feel comfortable in stepping out into the world having left the leadership of the school in good hands. We also want our next year's emerging Year 12 students to feel that they are responsible for the leadership that has naturally fallen to them.



## Intentionally Christian

As a School, we are always looking for ways to improve, and in 2022 our student leaders met to discuss ideas about what they could do to implement some changes to the Junior School.

One idea was to create a bike rack for the children who come on bikes, as previously, they were just leaving the bikes by the gate. They put a proposal together and Senior Leadership allowed for maintenance to pave an area near the front gate and to build a bike rack, suitable for scooters and bikes. There are plans to also put a cover over it so that the bikes do not get wet when it rains.

These are the things that make our Murray Bridge campus so special and a welcoming environment to be around. Our God-driven community, with a willingness to serve others, has seen this School grow not only in capacity, but also in faith, over these past few years.

## Pastoral Care

2023 is going to be an exciting year for the Middle School here at Murray Bridge. Our drive as a School is to build powerful and lifelong learners, so we are moving toward a focused Middle School teaching and learning approach.

Schooling is not just about improving academics but developing the child holistically. One of the exciting ways we will do this is by having a core teacher across most lessons, creating a space for strengthened Pastoral Care.

A key focus is on Middle School curriculum to be able to equip our Middle School students with skills for lifelong learning and providing opportunities for students to be active citizens in their communities.



*Pastoral Care*



*Intentionally Christian*



# Tyndale Generations

Old Tyndalian Journeys

Entering our 40th year as a School, our vision remains the same. It is imperative across our three campuses that we instil a sense of family and belonging in everything we do, because Tyndale is not just about what happens between Early Learning and Year 12, it is the lifelong memories and the connections that are created that makes this School so welcoming.

As a School we are proud that we have numerous generations entrenched in the Tyndale community, from old scholars to staff members having their own kids enjoy their bespoke Tyndale experience. Creating connections through generations ensures we stay in touch with families after their time at Tyndale and help create a future for their children, and their children.



## Salisbury East

Ged Pilon, Saskia and Jed Capon.





## Murray Bridge

Tania Gutteridge with her son Daniel and his daughter Evie.



## Strathalbyn

Marie Fergusson with her daughter Melanie and grand-children Parker and Ava.



# Then VS Now

## Forever Changing

One thing that ensures our School is maintaining its growth is continually transforming infrastructure to cater for our three ever-growing campuses.

Our Murray Bridge campus is no exception. In the space of twenty years, we transformed a dirt tarmac as far as the eye can see, with foliage and houses paralleling the strip, into a modernised School entrance, with a carpark, an administration building, and sports shed.

It is our commitment to the students and families at Tyndale that drives us to make positive changes to enhance their experience at the School. As we continue to evolve, our plans to help our lifelong learners reach their full potential also grows with the campus.



Back in the day



Today

### INTENTIONALLY

CHRISTIAN  
INCLUSIVE  
EXCELLENT

### SALISBURY EAST

50 Fern Grove Boulevard  
Salisbury East SA 5109  
phone 08 8282 5100  
salisburyeast@tyndale.sa.edu.au  
www.se.tyndale.sa.edu.au

### MURRAY BRIDGE

136a Adelaide Road  
PO Box 1460  
Murray Bridge SA 5253  
phone 08 8531 4600  
murraybridge@tyndale.sa.edu.au  
www.mb.tyndale.sa.edu.au

### STRATHALBYN

28 East Terrace  
PO Box 642  
Strathalbyn SA 5255  
phone 08 8536 5400  
strathalbyn@tyndale.sa.edu.au  
www.st.tyndale.sa.edu.au